

Wellmark Mizer® - Model 1110-111 Repair Kit

Installation instructions for Wellmark Model 6900 and Invalco controls

WARNING

User must isolate the control from signal pressure prior to disassembly and installation of this product. Failure to do so may result in free flow of gas during installation, property damage and/or personal injury. Always employ upstream and downstream pressure gauges to monitor startup pressures.

Application

This repair kit is designed to repair/replace damaged components within the Model 1110-111 Mizer for the Model 6900 controller.

Disassembly

Shut off supply pressure and process pressure to the controller. Loosen and remove jam nut (5) and c-ring (1) the MIZER pilot valve and blow out the supply line to remove any debris.

WARNING: Proceed very carefully with the disassembly and reassembly steps, as there are several extremely small parts, some of which are spring-loaded, which may become easily lost.

Unscrew and remove the spring retainer cap (7) from the bottom of the pilot valve body (3). Remove the spring (4) and internal poppet assembly (6) from the pilot valve body.

Carefully, unscrew and remove the nozzle tip (2) from the top of the pilot valve body taking care not to damage it. Remove top of the external poppet assembly (1).

Remove o-rings (8, 9, 10) from the spring retainer, nozzle tip and pilot valve body.

Clean and blow dry the pilot valve body, nozzle tip and spring retainer.

Re-assembly

Replace o-rings with new ones and position them within their proper grooves on the pilot valve body, nozzle tip and spring retainer, utilizing a light coat of lubricant on each o-ring.

Locate the new external poppet assembly. **CAUTION:** Prior to installation, assure that the cone-shaped portion of the seal is installed downward on the external poppet. Insert the new external poppet assembly into the top end of the poppet valve body.

Install the nozzle tip over the external poppet assembly and screw it into the top of the pilot valve body.

Install the nozzle tip over the external poppet assembly and screw it into the top of the pilot valve body.

Turn the assembly over and push the external poppet assembly into the nozzle Tip until it stops. Insert the new Internal poppet assembly into the rear of the pilot valve body, making sure that the "wire" end goes in first. (see illustration below) should drop cleanly through the seating area and the wire should insert into the external poppet assembly.

CAUTION! If you do not believe the internal poppet assembly properly engaged the external poppet assembly, DO NOT FORCE IT, as damage may occur. Also, DO NOT STRETCH the spring, as it is designed to work properly with a precise free height. Stretching the spring will negatively affect the proper function of the unit.

To assure proper assembly, push down on external poppet assembly. The poppet should move freely up and down. If the poppet hangs DO NOT FORCE IT! Disassemble the unit and reinstall until proper free travel is achieved. Although the external poppet assembly may exhibit a tendency to spring back, it is not necessary for proper function. It is only necessary that the poppet move freely, regardless of whether there is spring action.

Reinstall the repaired MIZER pilot valve into the controller head as directed on page 2. **NOTE:** There are two different [Item 11](#) o-rings, one for the Wellmark 6900 and one for the Invalco-style. Use the appropriate o-ring for your control and discard the other.

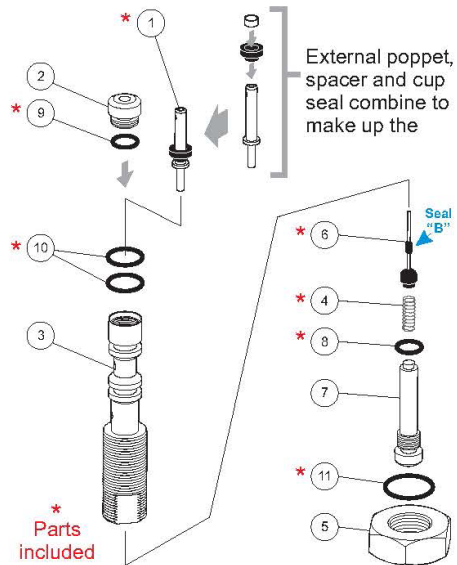

Why you can depend on genuine Norriseal-Wellmark products

- In-house engineering and technical support
- In-depth applications experience
- Award-winning innovation and ongoing product development
- ISO 9001 certified manufacturing
- Over five decades of industry service
- Compliance with all industry standards and specifications
- Responsive service and prompt delivery
- Field support available worldwide

Contact Norriseal-Wellmark for more information about our products and services.

Texas

Houston 713-466-3552

Oklahoma

Oklahoma City 405-672-6660

Louisiana

Broussard 337-837-3223



Follow us on LinkedIn.

Request for Quote

NRS_RFQ@championx.com

NorrisealWellmark.com

Norriseal-Wellmark | 11122 W Little York Rd | Houston, TX 77041 | T: +1 877-667-6418

This document is provided on an "as is" basis without warranties of any kind. Norriseal-Wellmark DISCLAIMS ALL WARRANTIES, EXPRESS OR IMPLIED, INCLUDING, BUT NOT LIMITED TO, IMPLIED WARRANTIES OF MERCHANTABILITY, FITNESS FOR A PARTICULAR PURPOSE OR SUITABILITY FOR ANY PURPOSE, TITLE, AND NON-INFRINGEMENT. While reasonable care has been taken in the preparation of this document, Norriseal-Wellmark does not represent or warrant that the contents of this document are accurate, complete, reliable, current or error-free.