

## MULTI-PORT FLANGED DIRECT MOUNT

PED   **SIL3**  
Safety Integrity Level

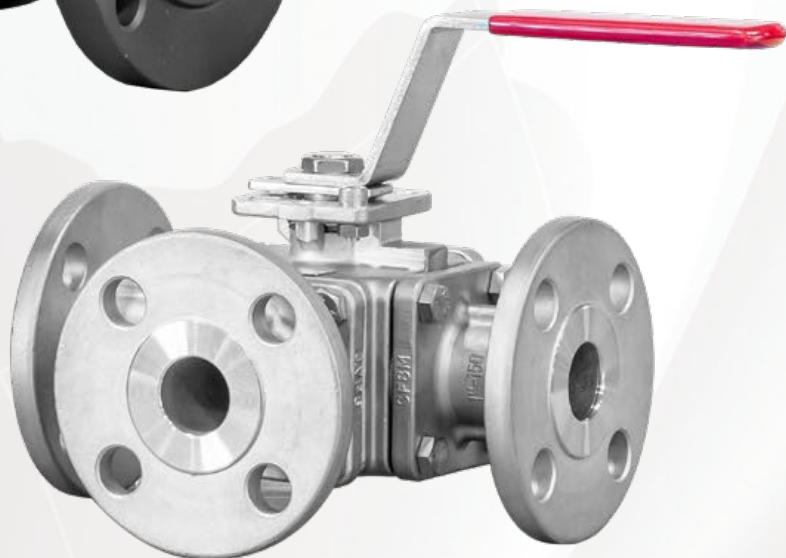
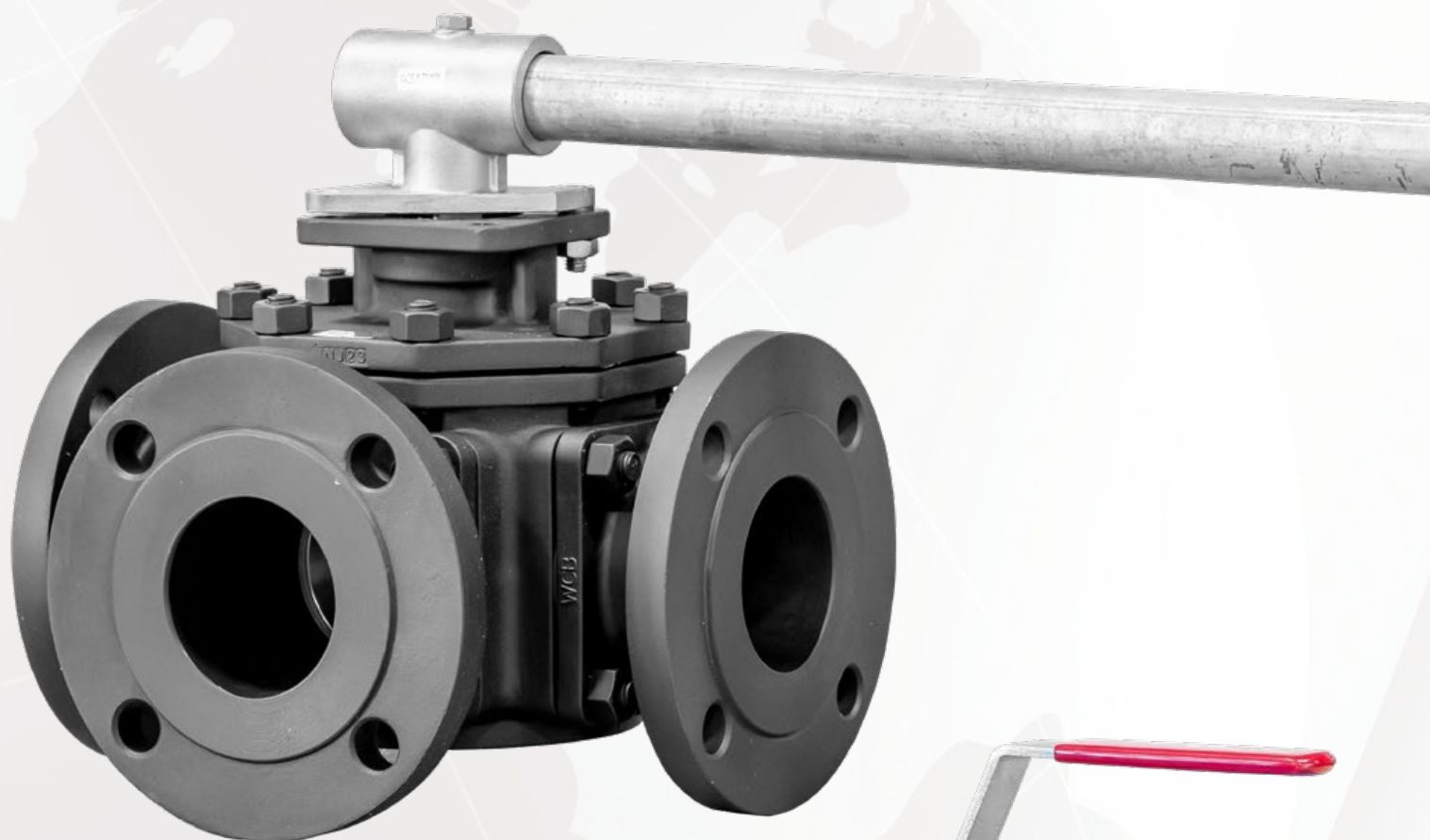

114 Resource Drive Wentzville, MO 63385 USA  
Tel: (636) 856-8576 - Fax: (636) 856-8930  
[www.sestovalves.com](http://www.sestovalves.com) - [sales@sestovalves.com](mailto:sales@sestovalves.com)

# Features & Benefits

## MM1F Series

### Class 150 Multiport Flanged Design



Class 150  
1/2" thru 12"

### Certifications and Compliance

Sesto Valves are designed and manufactured to internationally recognized standards including but not limited to the following:

**Testing:** API 598, ISO 5208

**Design:** ASME B16.34, ASME B16.5, ASME B16.10

**Markings:** MSS-SP-25, PED

**Certifications:** SIL, PED

### Features and Benefits

Class 150 Size

Range 1/2" thru 12" Full Bore

ISO 5211 Direct Mount (Up to 4")

Non Direct Mount 5"-12"

Body Material CF8M, WCB

Body Wall Thickness ASME B16.34

End Connections: RF Flanged

Anti-Static Device and Live-Loaded Packing

Bubble Tight Shut Off

Blowout Proof, Low Torque Guided Stem Design

Manual, Electric, Pneumatic Operators

### Versatility & Reliability

The Sesto Valves MM1F Series direct mount 3-way floating flanged ball valve design, starts with a high quality investment cast body, designed and tested in compliance with ASME B16.34 standards. Precision machined surfaces and tighter manufacturing tolerances allow for precise assembly and fitting of body components and seals. Because of reduced dimensional variations, seats can be designed for minimal compression. This results in lower, more consistent torques and longer seat life. Every valve is factory tested and serialized for quality control and traceability.

*This section intentionally left blank.*

## MM1F - Class 150 Design

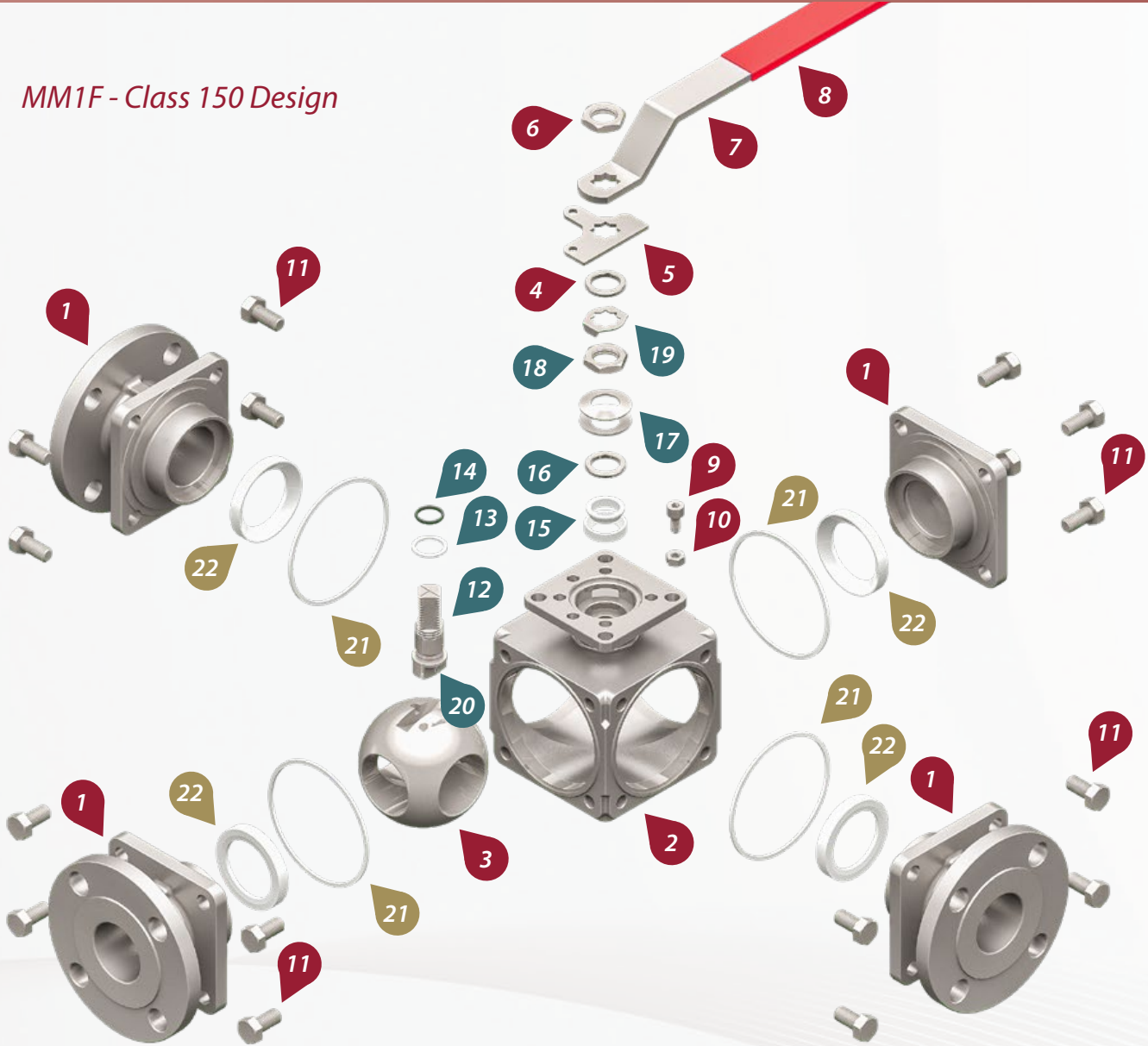

## MM1F - Class 150 Design

	#	PARTS	CF8M	WCB	#	PARTS	CF8M	WCB		
			STAINLESS STEEL	CARBON STEEL			STAINLESS STEEL	CARBON STEEL		
			(BODY CODE "S")	(BODY CODE "C")			(BODY CODE "S")	(BODY CODE "C")		
BODY & BALL	1	FLANGE END	ASTM A351 CF8M	ASTM A216 WCB	STEM & PACKING	12	STEM	SS316	SS316	
	2	BODY	ASTM A351 CF8M	ASTM A216 WCB		13	THRUST WASHER	RTFE	RTFE	
	3	BALL	ASTM A351 CF8M + HCR	ASTM A351 CF8M + HCR		14	O-RING	VITON	VITON	
	4	SPACE WASHER	SS 304	SS 304		15	STEM PACKING	PTFE	PTFE	
	5	STOP PLATE	SS 304	SS 304		16	GLAND	SS304	SS304	
	6	HANDLE NUT	SS 304	SS 304		17	BELLVILLE WASHER	304CSP	304CSP	
	7	HANDLE	SS 304	SS 304		18	STEM NUT	SS304	SS304	
	8	HANDLE SLEEVE	PLASTISOL	PLASTISOL		19	NUT STOP	SS304	SS304	
	9	STOP PIN	SS 304	SS 304		20	ANTI STATIC DEVICE	SS304	SS304	
	10	STOP PIN NUT	SS 304	SS 304		SEATS & SEALS	21	GASKET	TFM 1600	TFM1600
	11	FLANGE END BOLTS	ASTM A193-B8	ASTM A193-B7			22	SEAT	TFM	TFM

# Seat Guide & PT Chart

## Seat Guide\*

<b>TFM 1600 (MODIFIED PTFE)</b>
<b>RECOMMENDED</b>
Chemical Environments, Steam, Moderate Pressures
<b>NOT RECOMMENDED</b>
Fluorinated Chemicals
<b>TEMPERATURE</b>
-45°C to +232°C (-50°F to +450°F)
<b>COLOR</b>
 <b>Translucent White</b>

\* Seat material selection involves a large number of process variables and can be somewhat complex. If you do not have any experiential knowledge of what materials work well in your process, it is recommended that you contact Sesto Valves for guidance in selecting the appropriate materials. Selection of a non-optimal material can significantly shorten the valve's service life. This information is only provided as a general guideline of applications in which these seat materials are known to work well or are not recommended.

## Pressure Temperature Chart

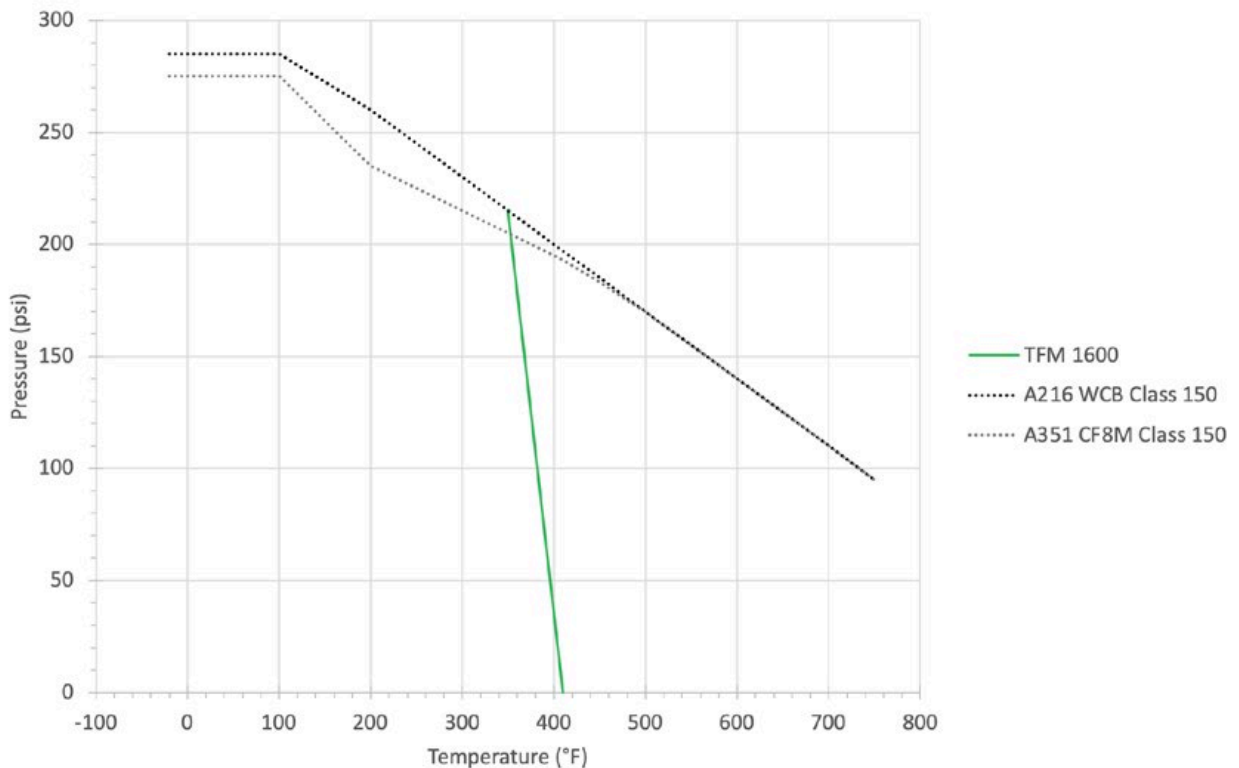

## Example Part Number

FIGURE	-	SIZE	-	BODY	TRIM	TYPE	SEATS	-	OPERATOR	-	SPECIAL
MM1F	-	01	-	C	6	0	F	-	N	-	

### EXAMPLE PART NUMBER: MM1F-01-C6LF-L

**EXAMPLE DESCRIPTION:** 1" MM1F SERIES FLOATING MULTI-PORT BALL VALVE, CLASS 150, L-PORT, FLANGED ENDS, ASTM A216 GR WCB BODY, ASTM A351 GR CF8M BALL, ASTM A276-316 STEM, TFM 1600 SEATS, VITON O-RING, TFM PACKING, B8 COVER BOLTS, W/ LOCKING LEVER HANDLE

FIGURE	-	SIZE	-	BODY	
MM1F - FLOATING MULTI-PORT 150# FLANGED BALL VALVE, FULL PORT	-	0M - 1/2" 0T - 3/4" 01 - 1" 1Q - 1 1/4"	1M - 1 1/2" 02 - 2" 2M - 2 1/2" 03 - 3"	04 - 4" 05 - 5" 06 - 6" 08 - 8"	C - ASTM A216 WCB S - ASTM A351 CF8M 9 - SPECIAL

TRIM	TYPE	SEATS	-	OPERATOR	-	SPECIAL
6 - 316 SS BALL / 316 SS STEM 9 - SPECIAL	T - T-PORT L - L-PORT	F - TFM 1600 9 - SPECIAL	-	N - BARE STEM L - LOCKING LEVER 9 - SPECIAL	-	CONSULT FACTORY

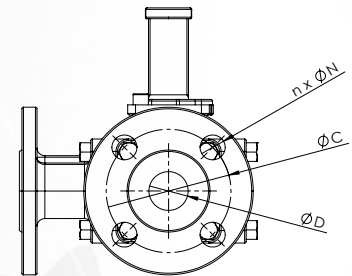
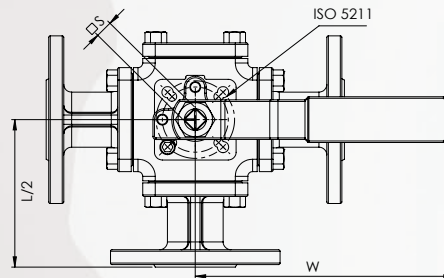
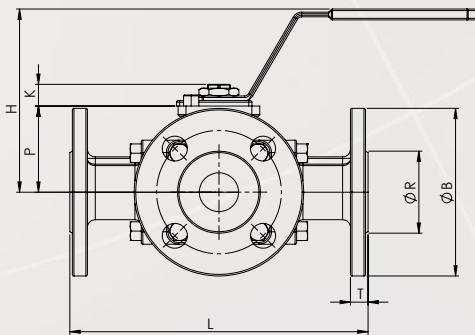
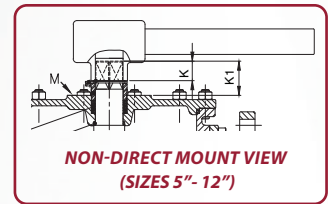

## MM1F - Class 150 Dimensions

SIZE (in)	D (in)	L (in)	T (in)	R (in)	C (in)	B (in)	P (in)	N (in)	n	H (in)	W (in)	S (in)	K (in)	K1 (in)	M	ISO 5211	L-PORT CV	T-PORT CV	WEIGHT (lb)	TFM 1600 Torque
1/2"	0.59	5.98	0.44	1.38	2.38	3.50	1.65	0.63	4	4.13	5.12	0.35	0.43	-	-	F03-F04	13	25	7.6	136
3/4"	0.79	6.57	0.44	1.69	2.76	3.86	1.91	0.63	4	4.33	6.50	0.43	0.55	-	-	F04-F05	23	46	8.9	164
1"	0.98	7.48	0.44	2.01	3.13	4.25	2.19	0.63	4	4.65	6.50	0.43	0.55	-	-	F04-F05	35	70	13.0	266
1.25"	1.26	8.19	0.50	2.52	3.50	4.61	2.48	0.63	4	4.65	8.07	0.55	0.67	-	-	F05-F07	n/a	n/a	*	586
1.5"	1.50	8.66	0.56	2.87	3.88	5.00	2.89	0.63	4	5.04	8.07	0.55	0.63	-	-	F05-F07	81	162	27.3	586
2"	1.97	9.96	0.62	3.62	4.74	5.98	3.64	0.75	4	5.51	12.80	0.67	0.83	-	-	F07-F10	153	309	46.8	763
2.5"	2.44	11.81	0.70	4.13	5.49	7.01	4.67	0.75	4	0.00	15.75	0.87	0.98	-	-	F10	186	376	62.7	1431
3"	2.99	12.01	0.75	5.00	6.00	7.48	5.37	0.75	4	0.00	19.69	0.87	0.98	-	-	F10	290	589	75.4	1567
4"	3.78	14.51	0.94	6.18	7.50	9.02	6.16	0.75	8	0.00	25.59	0.87	0.98	-	-	F10	466	941	142.5	2520
5"	4.92	16.46	0.94	7.32	8.50	10.00	5.53	0.87	8	10.04	33.86	1.10	2.32	1.42	M12	F12	*	*	*	4779
6"	5.91	16.81	1.00	8.50	9.51	11.00	6.28	0.87	8	11.57	47.24	1.42	2.44	1.42	M12	F12	1595	3222	266.9	5066
8"	7.87	20.94	1.13	10.63	11.75	13.50	7.91	0.87	8	13.19	59.06	1.42	2.44	1.42	M12	F12	2162	4368	507.8	6192
10"	9.76	25.98	1.19	12.76	14.25	16.00	9.92	1.00	12	15.55	78.74	1.42	2.99	1.69	M16	F14	*	*	*	8497
12"	11.65	31.57	1.28	15.00	17.01	19.02	11.97	1.02	12	19.69	98.43	1.81	4.33	2.76	M20	F16	*	*	*	11683

## Torques

Sesto Valves may change dimensions without any notice.

\*\*Raw torques shown in inch-pounds. Minimum 30% safety factor should be added for actuator sizing.\*\*



European Headquarters  
Agrate Brianza (MB) Italy

North American Headquarters  
114 Resource Drive Wentzville, MO 63385 USA  
Tel: (636) 856-8576 - Fax: (636) 856-8930  
[www.sestovalves.com](http://www.sestovalves.com) - [sales@sestovalves.com](mailto:sales@sestovalves.com)

Asian Office  
Jinan, China

Rev: 02/14/23