

FIRESAFE 2-PC

PED   NACE   **API 607** **API 608**

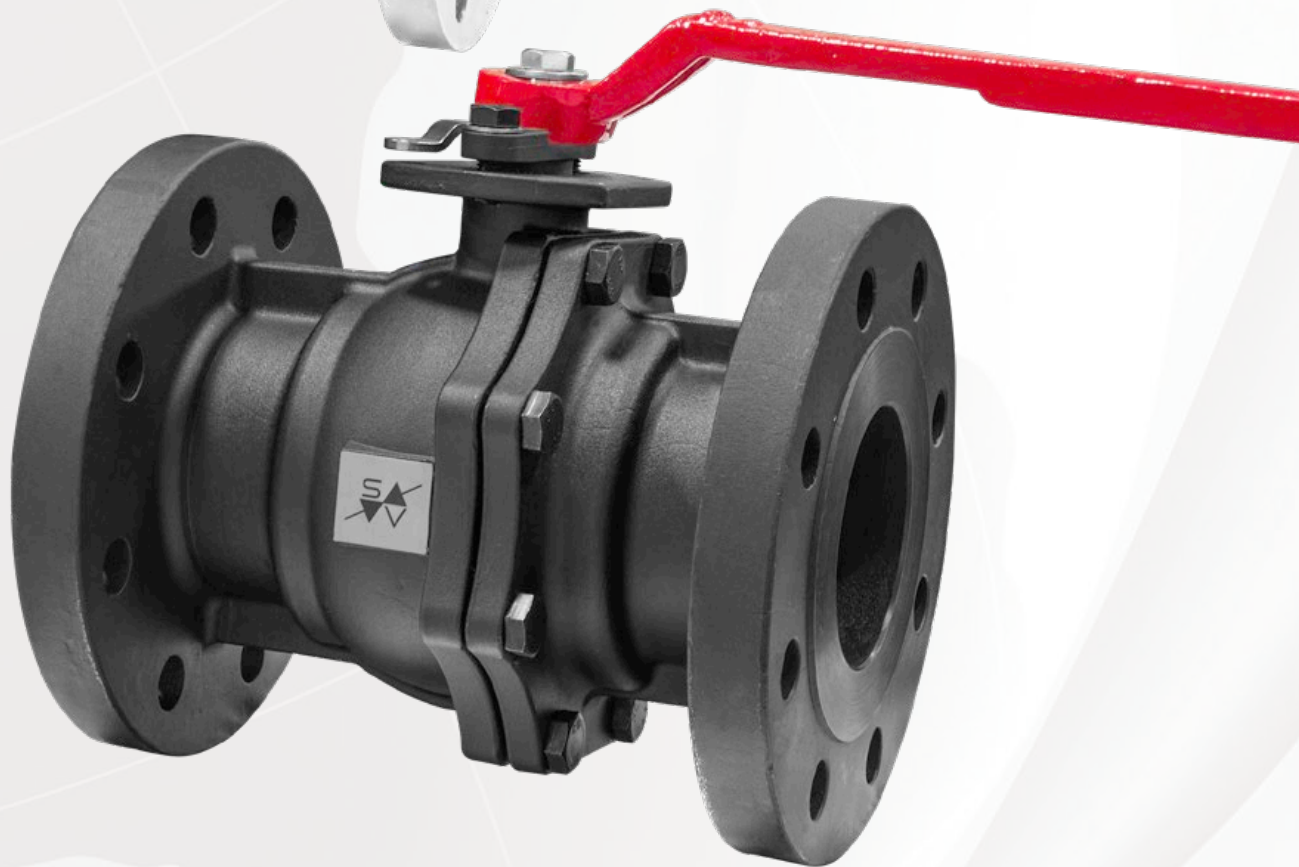
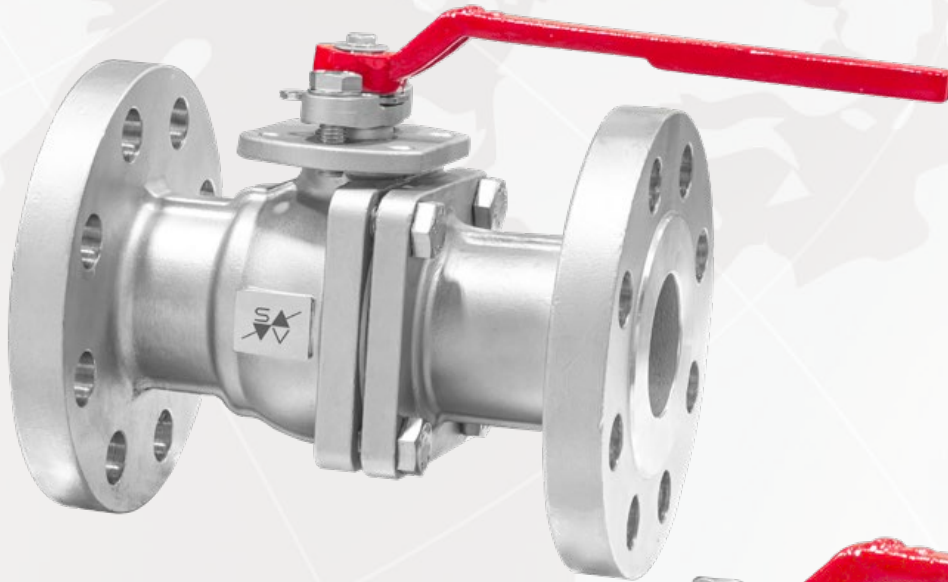

114 Resource Drive Wentzville, MO 63385 USA
Tel: (636) 856-8576 - Fax: (636) 856-8930
www.sestovalves.com - sales@sestovalves.com

Features & Benefits

M30F Series

Class 300 2-PC Flanged Design



Certifications and Compliance

Sesto Valves are designed and manufactured to internationally recognized standards including but not limited to the following:

Fire Testing: API 607 Certified

Testing: API 598, API 6D, ISO 15848, ISO 5208

Design: ASME B16.34, ASME B16.5, ASME B16.10, NACE MR0175, API 608

Markings: MSS-SP-25, PED, NACE

Certifications: API 607, SIL, NACE, PED, ISO 15848, API 608

Features and Benefits

Class 300

Size Range 1/2" thru 6" Full Bore

ISO 5211 Mounting

Body Wall Thickness ASME B16.34

End Connections: RF Flanged

Fugitive Emissions ISO 15848

Firesafe Tested API 607

Anti-Static Device and Live-Loaded Packing

Bubble Tight Shut Off

Blowout Proof, Low Torque Guided Stem Design

Wide Range of Soft and Metal Seated Options

Manual, Electric, Pneumatic Operators

Globally Certified and Approved

End Connections



Flanged
(RF)

Flow Control & V-Ball Solutions

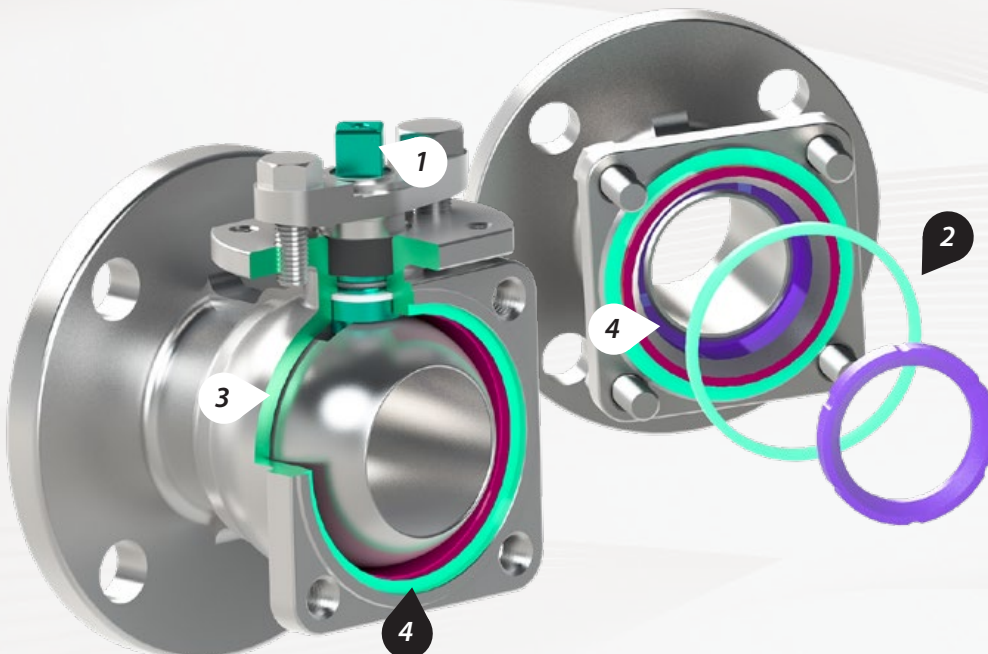
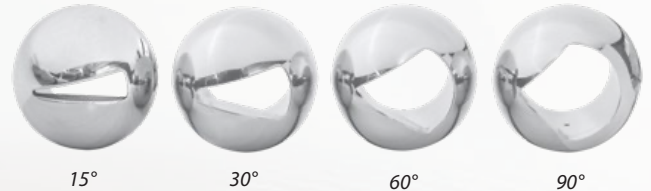

Fine-Tuned Design Details

(Four Improvements to the Industry Standard)

1. Larger Stem

Higher margin of safety, more resistant to side loading and fatigue stress.

2. Gaskets to Fill the Gaps

50% thicker than industry standard, graphite firesafe.

3. Thicker Body Walls

ASME B16.34 body wall thickness provides extra safety factor should the valve be overpressurized

4. Precision Machined Sealing Areas

Less dimensional variation allows for less seat compression, resulting in lower and more consistent torques.

Firesafe 2-PC Flanged, ISO 5211 Mount

ASME B16.34, API 608, API 607, ISO 15848, NACE MR-0175, Sil 2
 Certified Torques and Tolerances Verified for Consistency



#	PARTS	CF8M STAINLESS STEEL (BODY CODE "S")	WCB CARBON STEEL (BODY CODE "C")
1	BODY	ASTM A351-CF8M	ASTM A216-WCB
2	END CAP	ASTM A351-CF8M	ASTM A216-WCB
3	BALL	ASTM A351-CF8M/316	ASTM A276-304
4	BOLTS	ASTM A193 B8	ASTM A193 B8
5	THRUST WASHER	PTFE	PTFE
6	ANTI-STATIC DEVICE	AISI 316	AISI 316
7	O-RING	VITON**	VITON**
8	STEM	ASTM A276-316	ASTM A276-304
9	STEM PACKING	GRAPHITE	GRAPHITE
10	GLAND FOLLOWER	ASTM A351-CF8M	ASTM A216-WCB
11	GLAND BOLTS	ASTM A193 B8	ASTM A193 B8
12	HANDLE STOP	SS-AISI 304	SS-AISI 304
13	SNAP RING	SS-AISI 420	SS-AISI 420
14	BODY SIDE SEAT	REFER TO SEAT GUIDE	REFER TO SEAT GUIDE
15	END CAP SIDE SEAT	REFER TO SEAT GUIDE	REFER TO SEAT GUIDE
16	BODY GASKET	GRAPHITE	GRAPHITE

** Other Options Available Upon Request

Low Torque Design

Larger stem and seats with much less compression and precision machined sealing areas give us a consistent and reliable lower torque than our competitors.

Versatility & Reliability

The Sesto Valves M30F Series direct mount flanged floating ball valve design starts with a high quality investment cast body, designed and tested in compliance with ASME B16.34 standards. Precision machined surfaces and tighter manufacturing tolerances allow for precise assembly and fitting of body components and seals. Because of reduced dimensional variations, seats can be designed for minimal compression. This results in lower, more consistent torques and longer seat life. Every valve is factory tested and serialized for quality control and traceability.

Seat Guide & PT Chart

Seat Guide*

TFM 1600 (MODIFIED PTFE)	PTFE (VIRGIN PTFE)	50/50 (PTFE + 316SS)	RTFE (PTFE, GLASS FIBER REINFORCED)	CTFE (CARBON FILLED PTFE)
RECOMMENDED	RECOMMENDED	RECOMMENDED	RECOMMENDED	RECOMMENDED
Chemical Environments, Steam, Moderate Pressures	Most Chemicals, Low to Moderate Cycling	Saturated Steam, High Temperatures, Abrasives	Chemical Environments, Low Pressure Saturated Steam	Steam, Low to Moderate Pressures
NOT RECOMMENDED	NOT RECOMMENDED	NOT RECOMMENDED	NOT RECOMMENDED	NOT RECOMMENDED
Fluorinated Chemicals	High Cycle Applications, Fluorinated Chemicals	Chlorine Solutions	Caustic Chemicals	Caustic Chemicals
TEMPERATURE	TEMPERATURE	TEMPERATURE	TEMPERATURE	TEMPERATURE
-45°C to +232°C (-50°F to +450°F)	-45°C to +204°C (-50°F to +400°F)	-45°C to +288°C (-50°F to +550°F)	-45°C to +232°C (-50°F to +450°F)	-45°C to +249°C (-50°F to +480°F)
COLOR	COLOR	COLOR	COLOR	COLOR
 Translucent White	 White	 Dark Grey	 Off White	 Black

*Seat material selection involves a large number of process variables and can be somewhat complex. If you do not have any experiential knowledge of what materials work well in your process, it is recommended that you contact Sesto Valves for guidance in selecting the appropriate materials. Selection of a non-optimal material can significantly shorten the valve's service life. This information is only provided as a general guideline of applications in which these seat materials are known to work well or are not recommended.

Pressure Temperature Chart

M30F Series - Pressure vs. Temperature

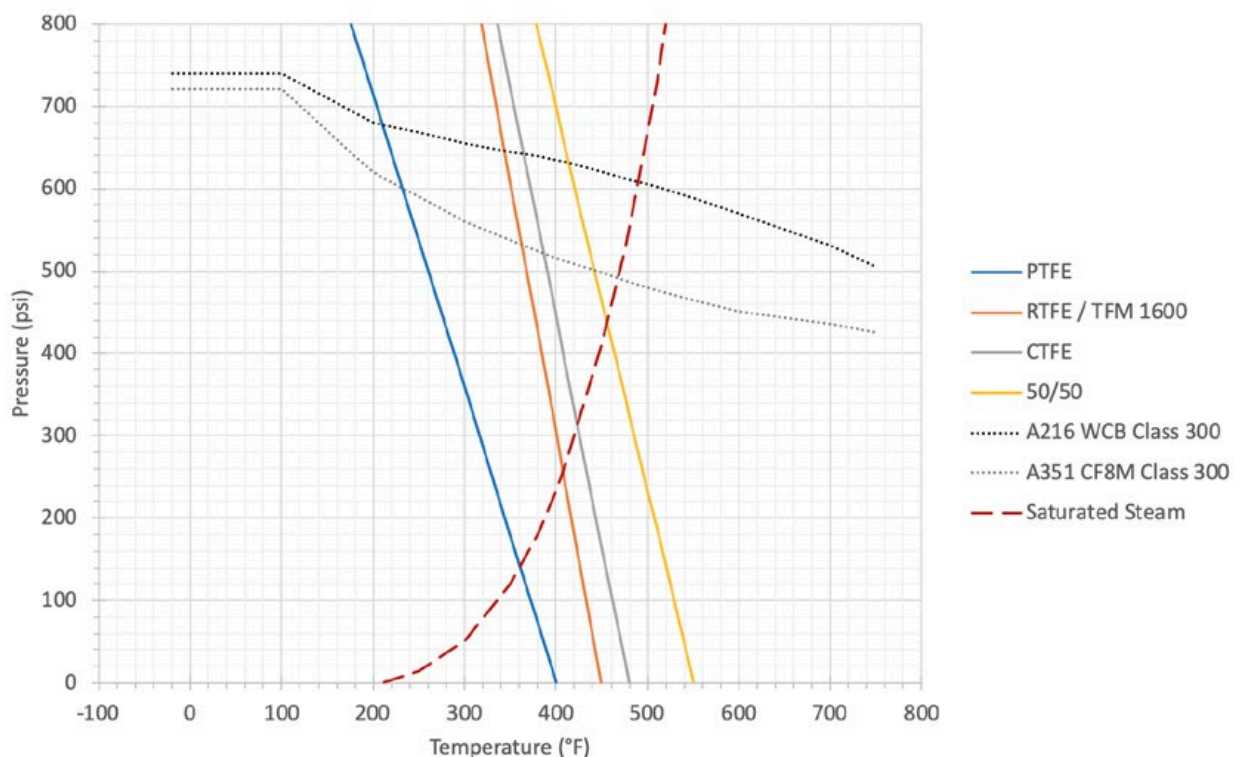

Example Part Number

FIGURE	-	SIZE	-	BODY	TRIM	TYPE	SEATS	-	OPERATOR	-	SPECIAL
M30F	-	03	-	C	6	0	F	-	N	-	

EXAMPLE PART NUMBER: M30F-03-C60F-N

EXAMPLE DESCRIPTION: 3" FLOATING 2-PC CLASS 300 FULL PORT BALL VALVE, SESTO M30F SERIES, RF FLANGED ENDS, ASTM A216 GR WCB BODY, ASTM A351 CF8M BALL, ASTM A276-316 STEM, STANDARD BALL TYPE, TFM 1600 SEATS, VITON O-RING, GRAPHITE FIRE SAFE PACKING, AISI 304 SS BOLTS, API 607, NACE, BARE STEM

FIGURE	-	SIZE	-	BODY
M30F - FLOATING 2-PC 300# FLANGED BALL VALVE, FULL BORE	-	0M - 1/2" 0T - 3/4" 01 - 1"	1M - 1 1/2" 02 - 2" 2M - 2 1/2"	03 - 3" 04 - 4" 06 - 6"
				C - ASTM A216 - WCB S - ASTM A351 CF8M 9 - SPECIAL

TRIM	TYPE	SEATS	-	OPERATOR	-	SPECIAL
6 - 316 SS BALL / 316 SS STEM 7 - 316 SS BALL / 17-4PH STEM 8 - 304 SS BALL / 304 SS STEM 9 - SPECIAL	0 - STANDARD V - V-PORT BALL P - OPEN PORT BALL S - SLOTTED BALL R - RELIEF VENTED BALL T - TEFLON IMPREGNATED BALL 9 - SPECIAL	F - TFM 1600 C - CTFE R - RTFE S - 50/50 T - PTFE 9 - SPECIAL	-	N - BARE STEM L - LOCKING LEVER E - OVAL HANDLE (2" & UNDER) 9 - SPECIAL	-	CONSULT FACTORY

Dimensions

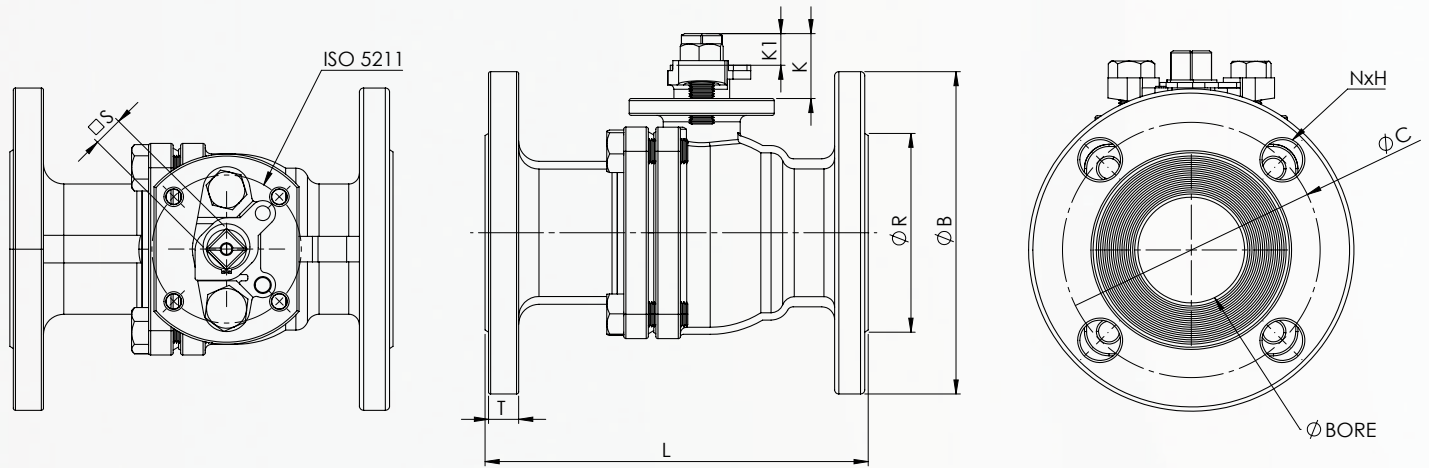

Dimensions (in)

SIZE (in)	BORE (in)	S (in)	ISO 5211	K (in)	K1 (in)	L (in)	T (in)	ØR (in)	ØC (in)	ØB (in)	ØH (in)	N	CV	WEIGHT (lbs)
1/2"	0.59	0.35	1.65	0.95	0.30	5.50	0.56	1.38	2.62	3.75	0.62	4	15	4.9
3/4"	0.79	0.35	1.65	0.95	0.30	6.00	0.62	1.69	3.25	4.62	0.75	4	35	7.1
1"	1.00	0.43	1.65	0.95	0.30	6.50	0.69	2.00	3.50	4.88	0.75	4	68	9.7
1 1/2"	1.50	0.55	2.76	1.24	0.43	7.50	0.81	2.88	4.50	6.12	0.88	4	155	18.1
2"	1.97	0.55	2.76	1.22	0.43	8.50	0.88	3.62	5.00	6.50	0.75	8	300	22.5
2 1/2"	2.56	0.67	2.76	1.60	0.61	9.50	1.00	4.12	5.88	7.50	0.88	8	500	34.2
3"	2.99	0.67	2.76	1.54	0.61	11.12	1.12	5.00	6.62	8.25	0.88	8	600	48.5
4"	3.94	0.87	4.02	1.65	0.71	12.00	1.25	6.19	7.88	10.00	0.88	8	1015	83.6
6"	5.91	1.06	4.92	2.11	1.18	15.88	1.44	8.50	10.62	12.50	0.88	12	4000	174.8

Sesto Valves may change dimensions without any notice.

Torques (in-lbs)

TFM 1600	PTFE	RTFE	CTFE	50/50
60	60	69	90	96
72	72	83	108	116
108	108	125	163	174
302	302	347	453	483
380	380	437	570	608
608	608	699	912	972
911	911	1047	1366	1457
1033	1033	1188	1550	1653
2696	2696	3101	4044	4314

Raw torques shown in inch-pounds. Minimum 30% safety factor should be added for actuator sizing.

Dimensions (mm)

SIZE (mm)	BORE (mm)	S (mm)	ISO 5211	K (mm)	K1 (mm)	L (mm)	T (mm)	ØR (mm)	ØC (mm)	ØB (mm)	ØH (mm)	N	CV	WEIGHT (kg)
15	15	9	42	24.10	7.62	140.00	14.22	35.10	66.50	95.30	15.75	4	15	2.20
20	20	9	42	24.10	7.62	152.00	15.75	42.90	82.60	117.30	19.05	4	35	3.20
25	25	11	42	24.10	7.62	165.00	17.53	50.80	88.90	124.00	19.05	4	68	4.40
40	38	14	70	31.50	10.90	190.50	20.57	73.20	114.30	155.40	22.35	4	155	8.30
50	50	14	70	31.00	10.90	216.00	22.35	91.90	127.00	165.10	19.05	8	300	10.20
65	65	17	70	40.65	15.50	241.00	25.40	104.60	149.40	190.50	22.35	8	500	15.50
80	76	17	70	39.10	15.50	282.00	28.45	127.00	168.10	209.60	22.35	8	600	22.00
100	100	22	102	41.90	18.00	305.00	31.75	157.20	200.20	254.00	22.35	8	1015	38.00
150	150	27	125	53.60	30.00	403.00	36.58	215.90	269.70	317.50	22.35	12	4000	79.50

Sesto Valves may change dimensions without any notice.

Torques (Nm)

TFM 1600	PTFE	RTFE	CTFE	50/50
7	7	8	10	11
8	8	9.5	12	13
12	12	14	18	20
34	34	39	51	54.5
43	43	49	64	68.5
68.5	68.5	79	103	110
103	103	118	154	164
116.5	116.5	134	175	186.5
304	304	350	456	487

Raw torques shown in inch-pounds. Minimum 30% safety factor should be added for actuator sizing.



European Headquarters
Agrate Brianza (MB) Italy

North American Headquarters
114 Resource Drive Wentzville, MO 63385 USA
Tel: (636) 856-8576 - Fax: (636) 856-8930
www.sestovalves.com - sales@sestovalves.com

Asian Office
Jinan, China

Rev: 10.16.2020