

Trunnion

PED



NACE



SIL2
 Safety Integrity Level

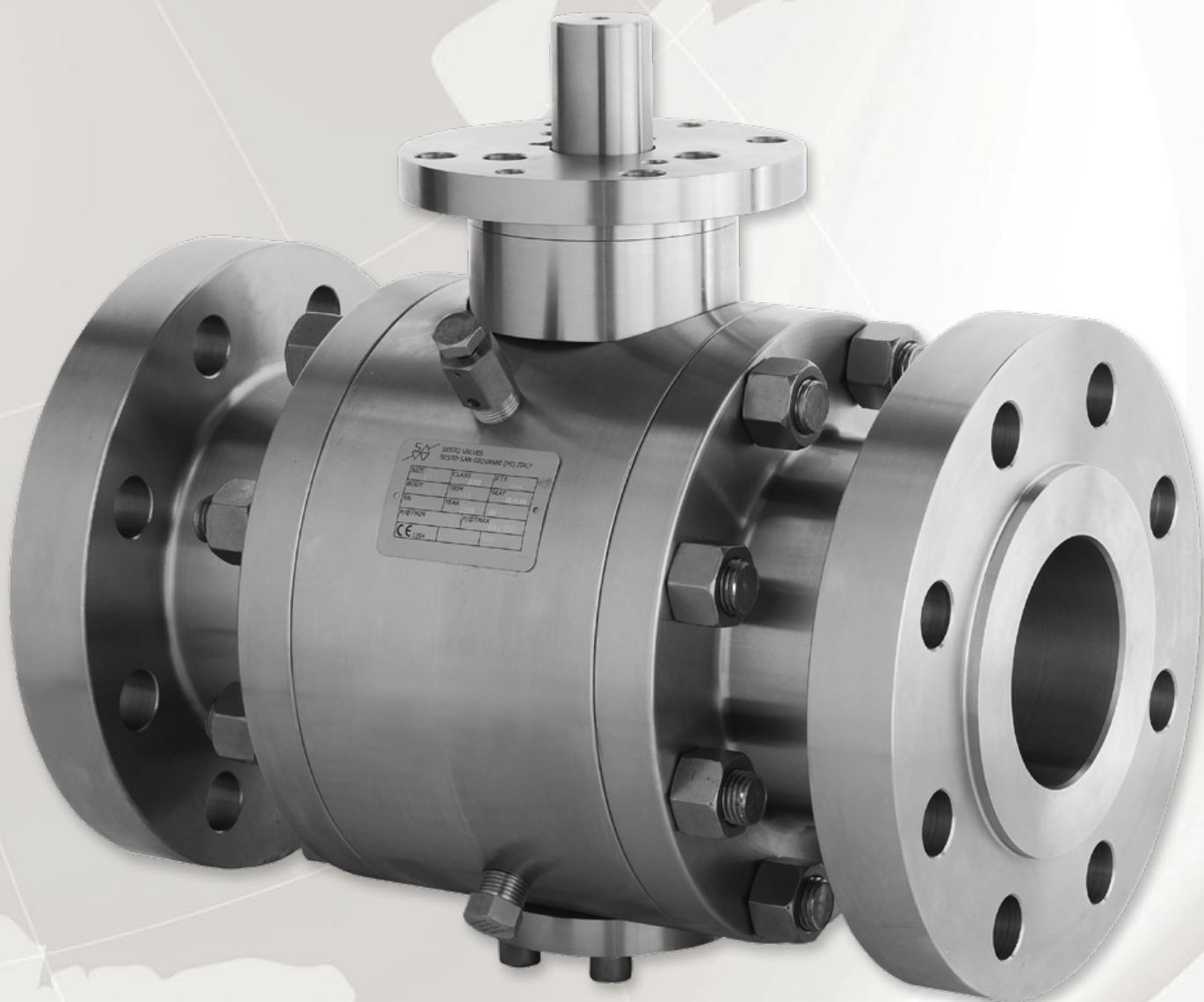

Worldwide Headquarters | Tel: +39.039.902.0888 - Fax: +39.039.902.0889
 North American Headquarters | Tel: +1.636.856.8576 Fax: +1.636.856.8930
www.sestovalves.com | sales@sestovalves.com

Introduction

Sesto Valves specializes in custom designed ball valve solutions for the chemical, petrochemical and energy industries. Applications include cryogenics, extreme high temperatures, metal seated applications, as well as specialty double block and bleed emergency shutdown valve solutions. Headquartered in Agrate Brianza (MB) Italy, we are a premium ball valve manufacturer with over 30+ years of engineering experience. Our valves are 100% designed, manufactured, and tested in Italy with complete control of product quality and material traceability. We source only the best materials from local and global partners to ensure quality and competitive pricing.

Our philosophy is to make valves that fit your application, not the other way around. We match materials and trims to maximize performance and reliability, with ready access to special coatings and exotic or super alloys. Our engineers design valves to optimize fit and function, including special face-to-face, multiport or combination valves for cost and space savings. Our quality team inspects every component and runs extensive performance tests for design verification and production phases, and can also include your own customer specified testing. In order to provide a more complete solution, we partner directly with key valve automation industry leaders to provide actuation and automation controls in a comprehensive valve package. Contact Sesto Valves today with your most difficult valve application and we'll give you our best resources and expertise to help you reach your goals.

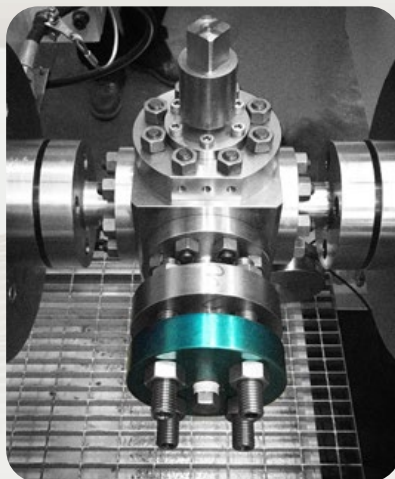
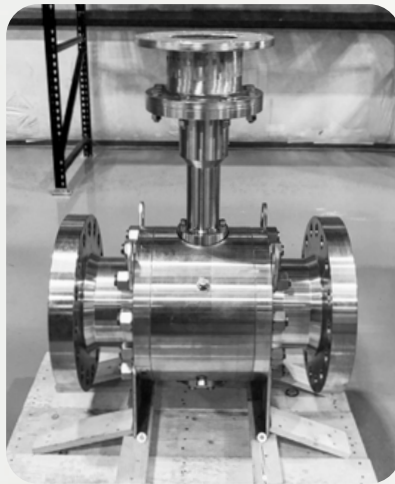

Europe
World Headquarters
Sesto SG, Italy
Via Socrate, 10
20864 Agrate Brianza (MB)
Italy
Tel: +39.039.902.0888
Fax: +39.039.902.0889



North America
Wentzville, Missouri
114 Resource Drive
Wentzville, MO 63385
United States
Tel: +1.636.856.8576
Fax: +1.636.856.8930

Features and Benefits

Class 150 to Class 2500
 Size Range ½" thru 36" (Class Dependent)
 Full and Reduced Bore
 Body Wall Thickness ASME B16.34
 End Connections: RF, RTJ, BW, SW, NPT, BSP, Special
 Fugitive Emissions ISO 15848
 Fire-Safe Tested API 607
 Emergency Sealant Injectors Optional
 Anti-Static Device and Live-Loaded Packing
 Guided Seat Design
 Blowout Proof, Low Torque Guided Stem Design
 Wide Range of Soft and Metal Seated Options
 Manual, Electric, Pneumatic,
 or Electro-Hydraulic Operators Available
 Custom Face-to-Face Lengths Available

Versatility & Reliability

The Sesto Valves trunnion mounted ball valve design allows for the use of all types and materials of construction and may be installed in any flow configuration and orientation. Customizable spring configurations and guided seat design gives the option for a carbon steel body and end enclosures with a duplex or stainless seat module. Metal seated options are available for a variety of high temperature, corrosive, or abrasive applications. Our experienced team of engineers can design and build the right valve for your exact requirements. Sesto trunnion ball valves are Sil 2 certified, fire tested, FE tested, and built for application specific versatility and long term reliability.

End Connections



Flanged
(RF)

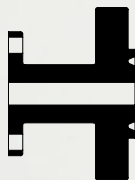

Ring Type
Joint (RTJ)



Butt Weld
(BW)



Threaded
(NPT)



Socket Weld
(SW)

150# to 2500#
½" thru 36"

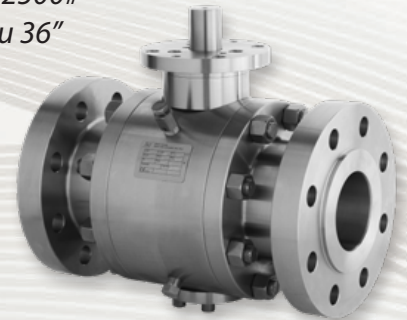

Certifications and Compliance

Sesto Valves are designed and manufactured to internationally recognized standards including but not limited to the following:

Design: API 6D

Fire Testing: API 607, API 6FA, BS 6755 Part II

Testing: API 6A, API 598, API 17D, ISO 5208, BS 6755 Part I, BS 6364

Marking: API 6A, MSS-SP-25, PED

Certifications: API607, SIL, NACE, MR0175, PED, Fugitive Emissions

Partial List of Applications

Oil & Gas Pipelines	Offshore Platforms
Refineries and Petrochemical Plants	HIPPS Systems
Power Generation	Cryogenic Service Applications
Gas and Coal Fired Turbines	Emergency Shut Down Valves
District Heating	Pulp & Paper
Gas Measurement Systems	Mining
	Boiler Steam and Drain Applications

Why Sesto?

Sesto Multiport Design	The Sesto Difference
Precision Machined Forged Body	The forged body eliminates the possibility of leakage due to poor castings. Precision finish machining keeps tight tolerances to ensure secure assembly for high pressure, critical applications.
Ball/Seat Lapping	Lapping seats to the ball ensures tight tolerances, improving shut-off sealing capability while lowering torque requirements.
Guided Seat Design	The guided seat design allows for flexibility in materials of construction (end closures vs. seats vs. body), customizable spring configurations for specific pressure relief set points, and ease of maintenance. This design also ensures better concentricity between sealing components to improve sealing performance.

Trunnion Design

Fire-Safe & Fugitive Emissions Certified

Packing arrangement is fire-safe for critical applications and Fugitive Emissions ISO 15848 certified.

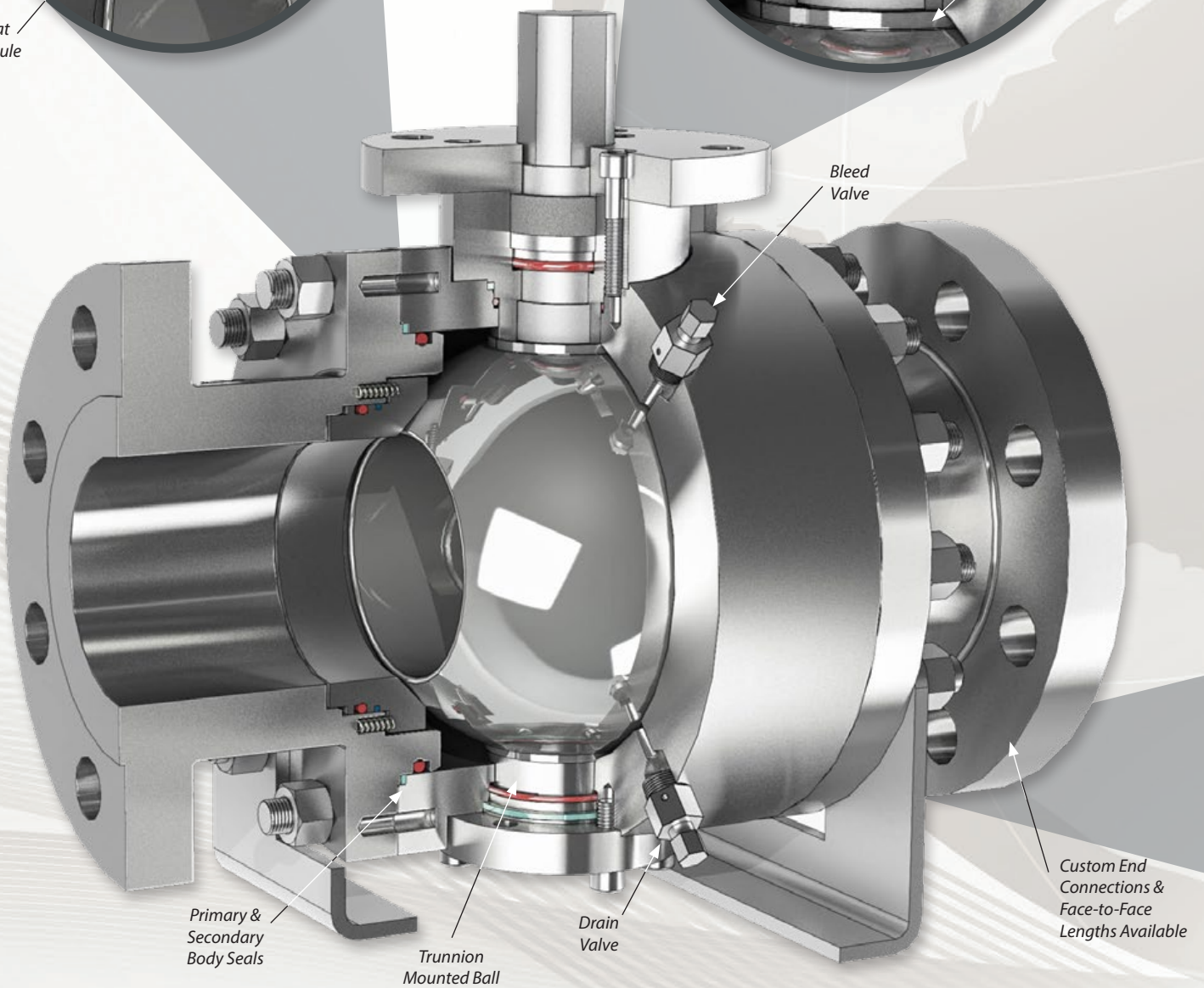
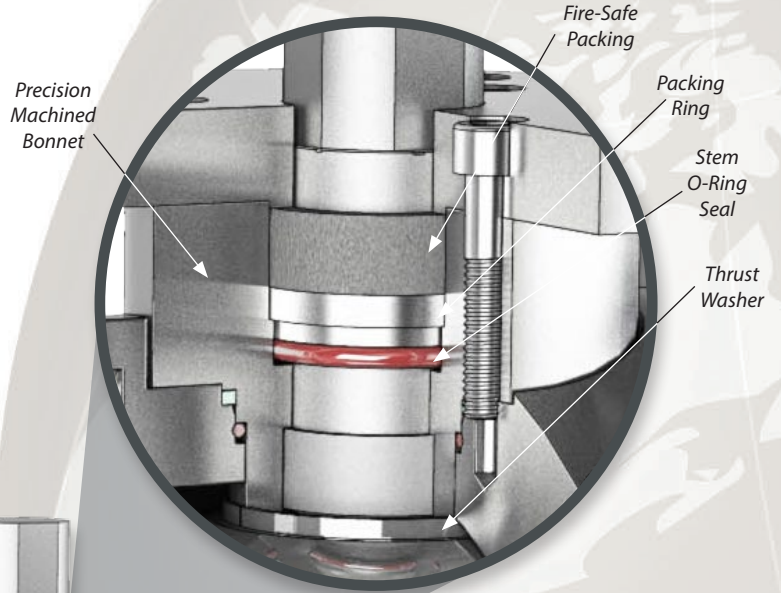
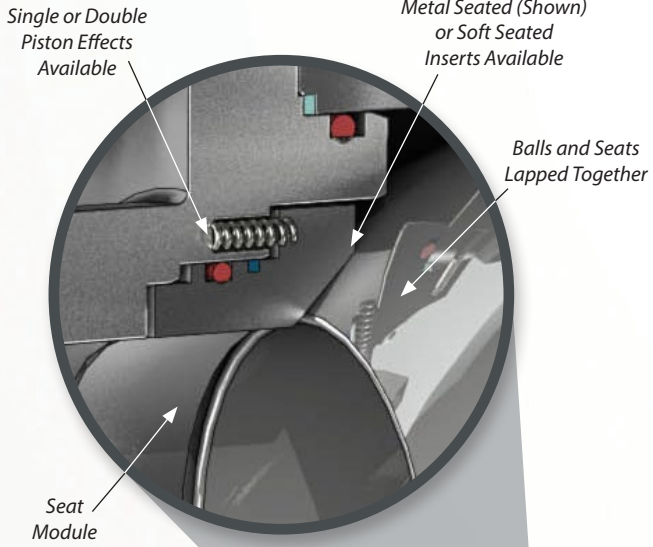

Ball/Seat Lapping

Lapped ball and seat sets are utilized when materials and sealing requirements dictate. This precise manufacturing process ensures the lowest operating torque and the tightest possible sealing capability of the ball and seats, while at the same time providing for an exceptionally long service life for the intended application. Lapping is a surface finishing process where extremely fine polishing compounds are used as the lapping agent to achieve remarkably close mating surfaces.



Guided Seat Design

Sesto Valves Guided Seat Design surrounds the seat module within the end closure, eliminating the need to seal against the center body and minimizing leak paths. The sliding seals on the seat module are no longer part of the critical body seal pathway.

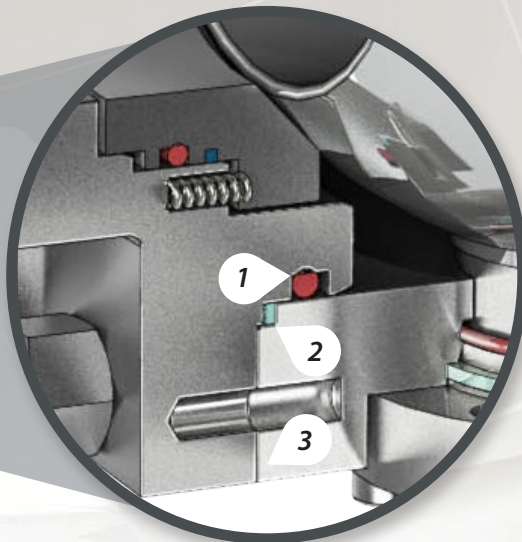
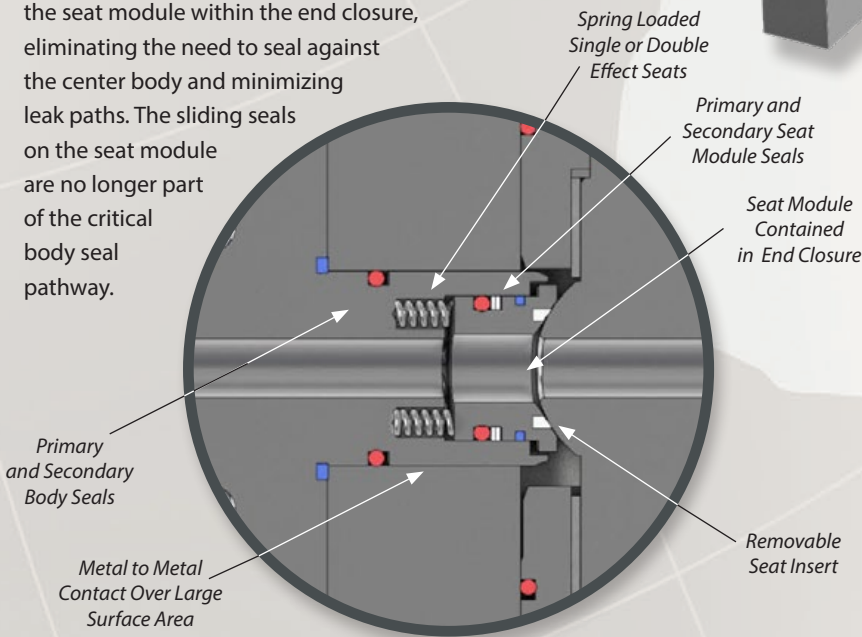

Extended End Closure

Guides Springs and Seat Module

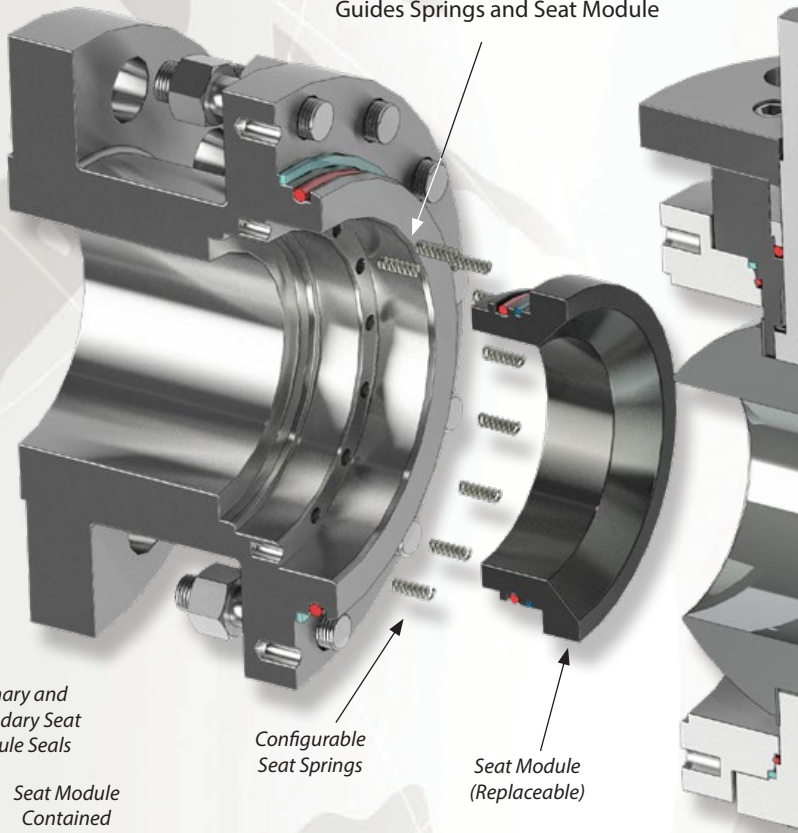

Options

- Emergency Shutdown (ESD) Valves
- Welded Body for Municipal Heating
- Cryogenic
- Metal-Seated
- Double Block and Bleed
- Double Isolation and Bleed

Triple Body Seal

(Providing Three Levels of Defense)

- 1. Primary Body Seal (RPTFE)**
Soft seal for reliable sealing at all pressures
- 2. Secondary Body Seal (Graphite)**
Provides a fire safe secondary seal.
- 3. Backup Metal-to-Metal Interface**
Forms a labyrinth seal with a torturous flow path.



Worldwide Headquarters
Via Socrate, 10, 20864 Agrate Brianza (MB) Italy
Tel: +39.039.902.0888 | Fax: +39.039.902.0889

North American Headquarters
114 Resource Drive Wentzville, MO 63385 USA
Tel: +1.636.856.8576 Fax: +1.636.856.8930

Web: www.sestovalves.com | Email: sales@sestovalves.com

Rev. Jan. 26, 2022